

**ED-6C157-31 Groups 11, 12, 13, 14, 17, and 18
Complete Bay Framework Groups For
Bantam Plus and 800-Series Systems
Installation Procedures**

General

This instruction sheet provides procedures for installing ED-6C157-31 framework hardware groups for Bantam Plus and 800-Series Systems. These groups are comprised of complete framework hardware including vertical troughs and associated label sets (labels, label holders, and covers). The vertical troughs in these groups may also be ordered separately from ED-6C157-30.

How to Contact Us

- To find out more about **Carrier Apparatus** products, visit us on the web at: <http://cw.commscope.com/>
- For technical assistance regarding Carrier Apparatus products: contact your local CommScope account representative or CommScope technical support at 1-800-344-0223.
- Report any missing or damaged parts to CommScope customer service in Omaha, Nebraska, at 1-866-539-2795.

References

- 365-301-120 — *800-Series and 900-Series DSX-1/1C, System Reference Guide*
- 365-301-125 — *Bantam Plus DSX-1/1C, System Reference Guide*
- 365-301-131 — *DIXI-3 System, System Reference Guide*
- ED-6C156-10 — *Bantam Plus DSX-1/1C System, Engineering and Ordering*
- ED-6C157-10 — *DSX Framework Hardware Engineering, Ordering, and Installation*
- ED-6C157-30 — *DSX Framework Hardware Groups*
- ED-6C157-31 — *DSX Framework Hardware Groups*

Tools Required

- Screw-starter
- Flat-blade 0.2-inch (5 mm) wide, 6-inch long (152 mm) screwdriver

Ordering Information

ED-6C157-31 Group No.	Material ID	Description
Group 11	601 446 602	Basic framework hardware for 18-inch (457 mm) D bay for Bantam Plus system's staggered jack panels (rear cabled/front cross-connected).
Group 12	601 446 610	Basic framework hardware for 18-inch (457 mm) D bay for Bantam Plus system's staggered jack panels (rear cabled/front cross-connected).
Group 13	601 446 628	10 full vertical troughs, 10 label sets, and 20 label holders and covers.
Group 14	601 446 636	10 half vertical troughs, 10 label sets, and 10 label holders and covers.
Group 17	601 465 834	Basic framework hardware for a 18-inch (457 mm) Dbay for the Enhanced 800-Series DSX.
Group 18	601 465 842	Basic framework hardware for a 15-inch (381 mm) D bay for the Enhanced 800-Series DSX.

GROUP 11, 12, 17, AND 18 INSTALLATION—BANTAM STAGGERED JACK AND ENHANCED 800-SERIES DSX

Refer to Figure 1 for the mounting positions of the framework hardware mounted on the front and rear of the bay frame. Figure 2 on page 5 shows an exploded view of Group 11 and 12.

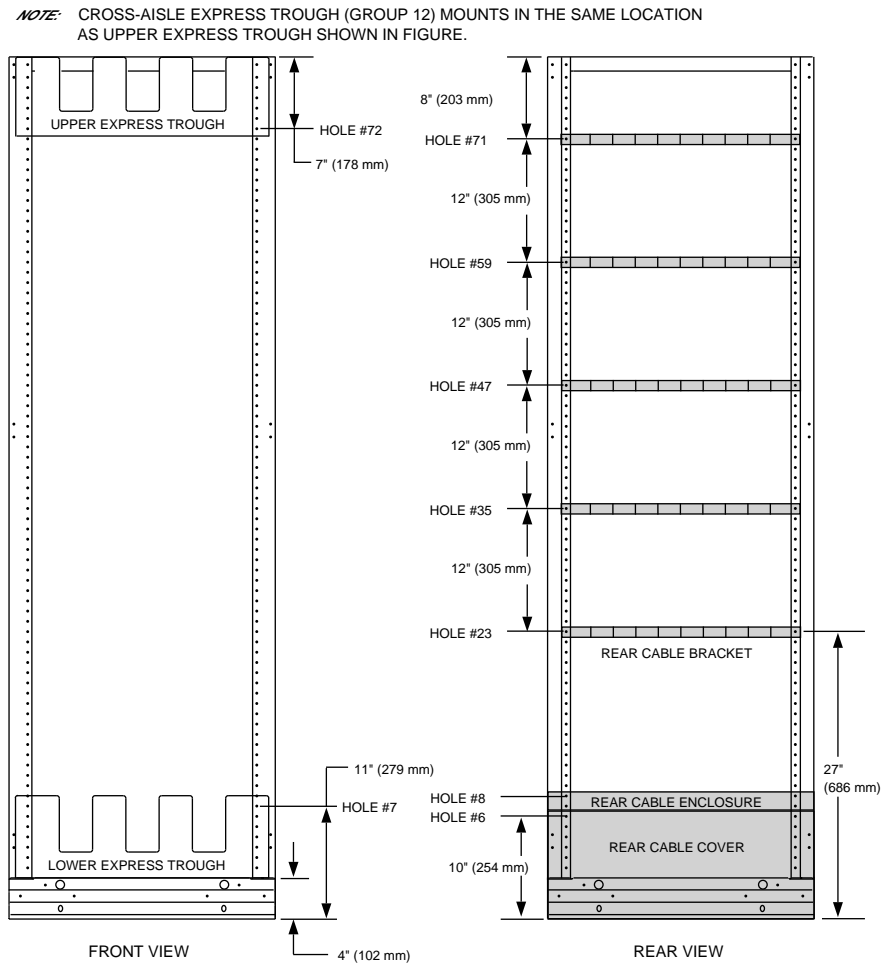

Figure 1. Mounting Positions—Group 11, 12, 17, and 18 Framework Hardware

GROUP 11, 12, 17, AND 18 INSTALLATION—BAY SPACER HARDWARE

Refer to Figure 2 on page 5.

1. Fasten the upper express trough (for Group 12—upper cross-aisle express trough) to the bay frame with eight No. 12-24 by 3/8-inch (9.5 mm) screws.
2. Fasten the lower express trough to the bay frame with six No. 12-24 by 3/8-inch (9.5 mm) screws.
3. Fasten the jumper retainers to the lower express trough with four No. 12-24 by 3/8-inch (9.5 mm) screws.
4. Fasten the rear cable brackets to the rear of the bay frame with two No. 12-24 by 3/8-inch (9.5 mm) screws.
5. Fasten rear cable cover to bay frame with four No. 12-24 by 3/8-inch (9.5 mm) screws.
6. If using overhead cabling, slide rear cable cover over top screws of rear cable cover.
7. If installing Groups 11, 12, 17, or 18 in lineup with spacing between adjacent bays, fasten the lower trough extension bracket to the lower express troughs (of adjacent bays) with two No. 12-24 by 3/8-inch (9.5 mm) screws.
8. Install bridging panel by sliding the panel over adjacent rear cable covers.

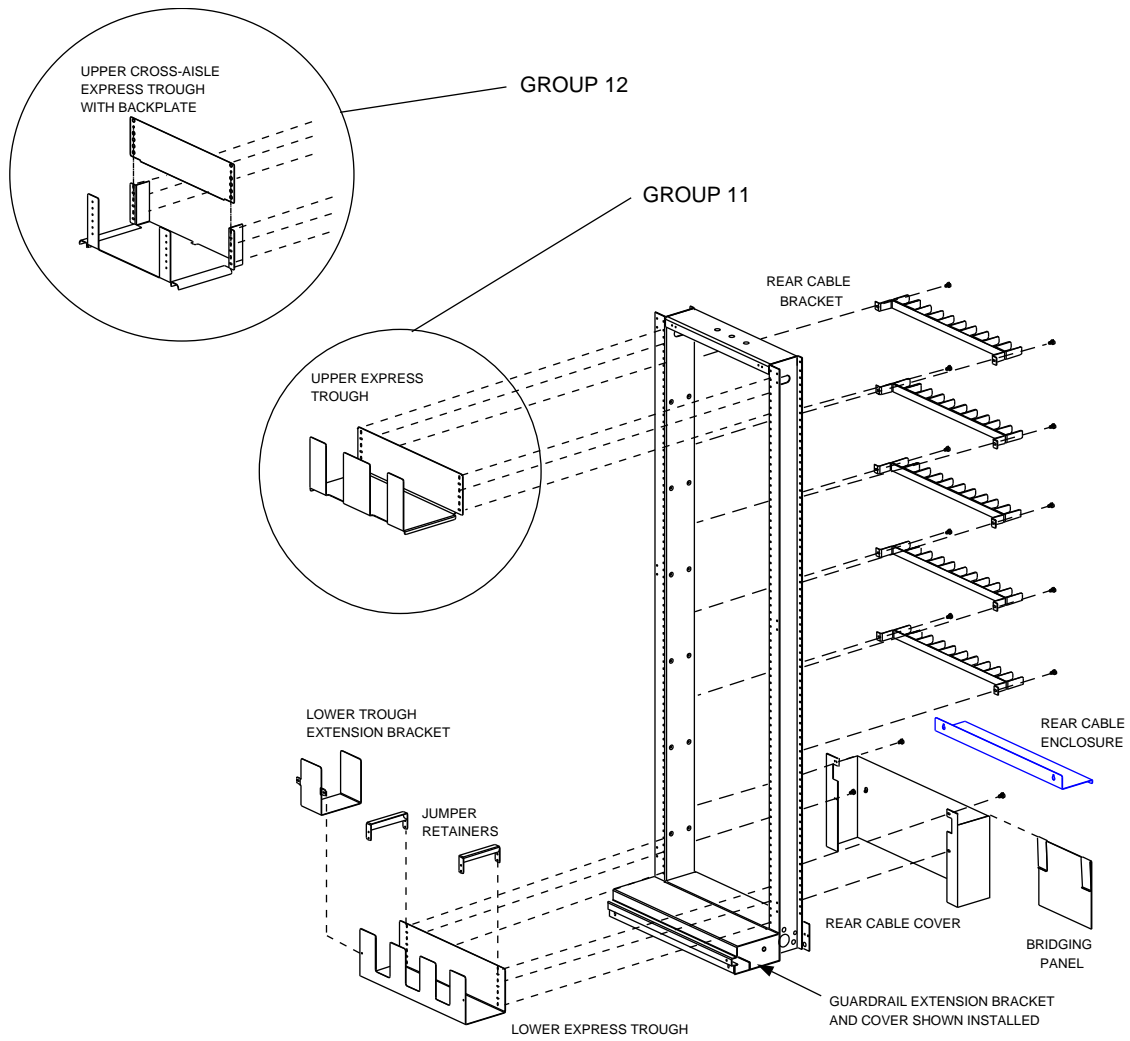

Figure 2. Installing Group 11, 12, 17, and 18 Framework Hardware

GROUP 13 INSTALLATION— BANTAM STAGGERED-JACK AND ENHANCED 800-SERIES DSX

Each ED-6C157-31 Group 13 provides ten full vertical troughs, ten label sets, and twenty label holders and clear vinyl covers (see Figure 3). Note that in the *FRONT VIEW* of the bay frame twenty vertical troughs (two Group 13s) are shown.

- 1. Mount each vertical trough to frame upright on wide flange side (front) of bay frame with four No. 12-24 by 3/8-inch (9.5 mm) screws each.
- 2. Slide label holders onto vertical troughs and *snap-lock* holder close.
- 3. Slide appropriate label and clear vinyl cover into label holder.

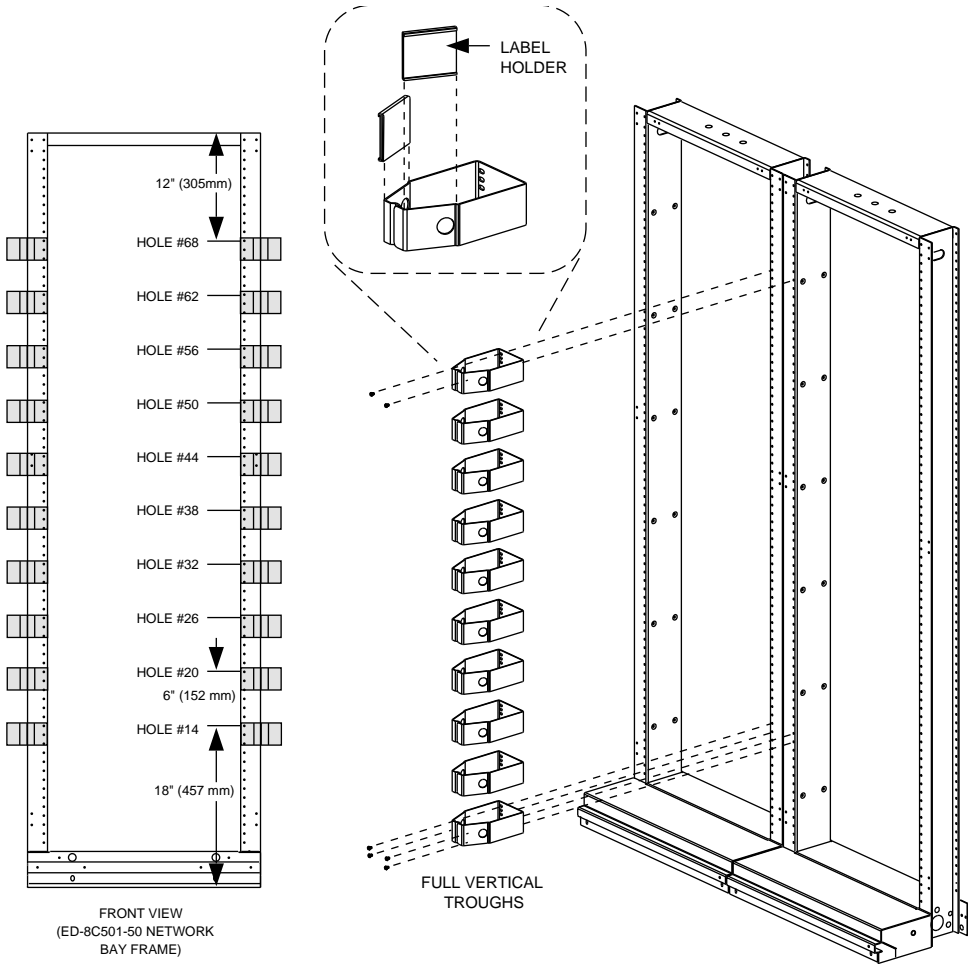

Figure 3. Installing Group 13 Framework Hardware

GROUP 14 INSTALLATION—BANTAM STAGGERED-JACK AND ENHANCED 800-SERIES DSX

Each ED-6C157-31 Group 14 provides ten half vertical troughs, ten label sets, and ten label holders and clear vinyl covers. This group is designed for Bantam Rear/Front Staggered-Jack and 800-Series DSX applications and shown in Figure 4.

1. Mount each vertical trough to frame upright on wide flange side (front) of bay frame with four No. 12-24 by 3/8-inch (9.5 mm) screws each.
2. Slide label holders onto vertical troughs and *snap-lock* holder close.
3. Slide appropriate label and clear vinyl cover into label holder.

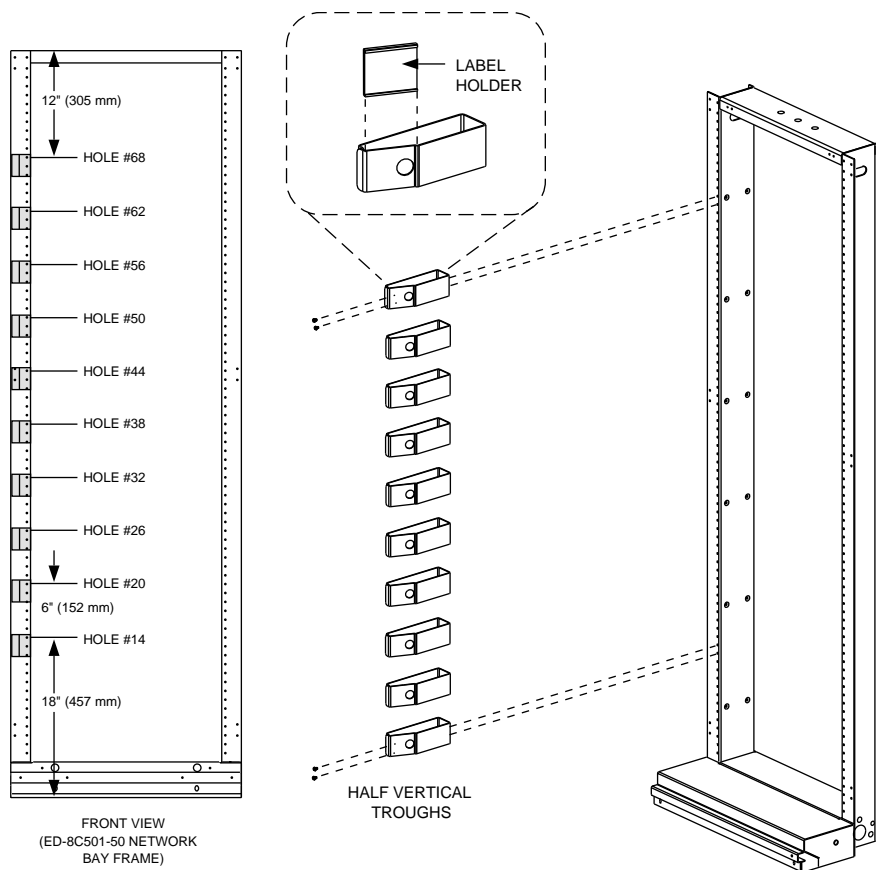

Figure 4. Installing Group 14 Framework Hardware